



Goodhall Close

Stanmore

£750,000

An end-of-terrace, four bedroom, modern house available with Davidson Frost-Wellings.

On the ground floor the house has a large, open plan kitchen/living room as well as a downstairs bedroom and shower room. On the first floor is a spacious reception room with double doors leading to a balcony, plus a master bedroom and ensuite shower room, and on the top floor are two double bedrooms and a family bathroom.

The house further benefits from off-street parking and a private rear patio garden, as well as a separate studio in the garden.

Harrow Council tax band F

Viewing

Please contact our Davidson Frost-Wellings Office on 020 8954 8806 if you wish to arrange a viewing appointment for this property or require further information.

- Four bedrooms
- Three bathrooms
- End of terrace townhouse
- Private rear garden
- Off street parking
- Freehold

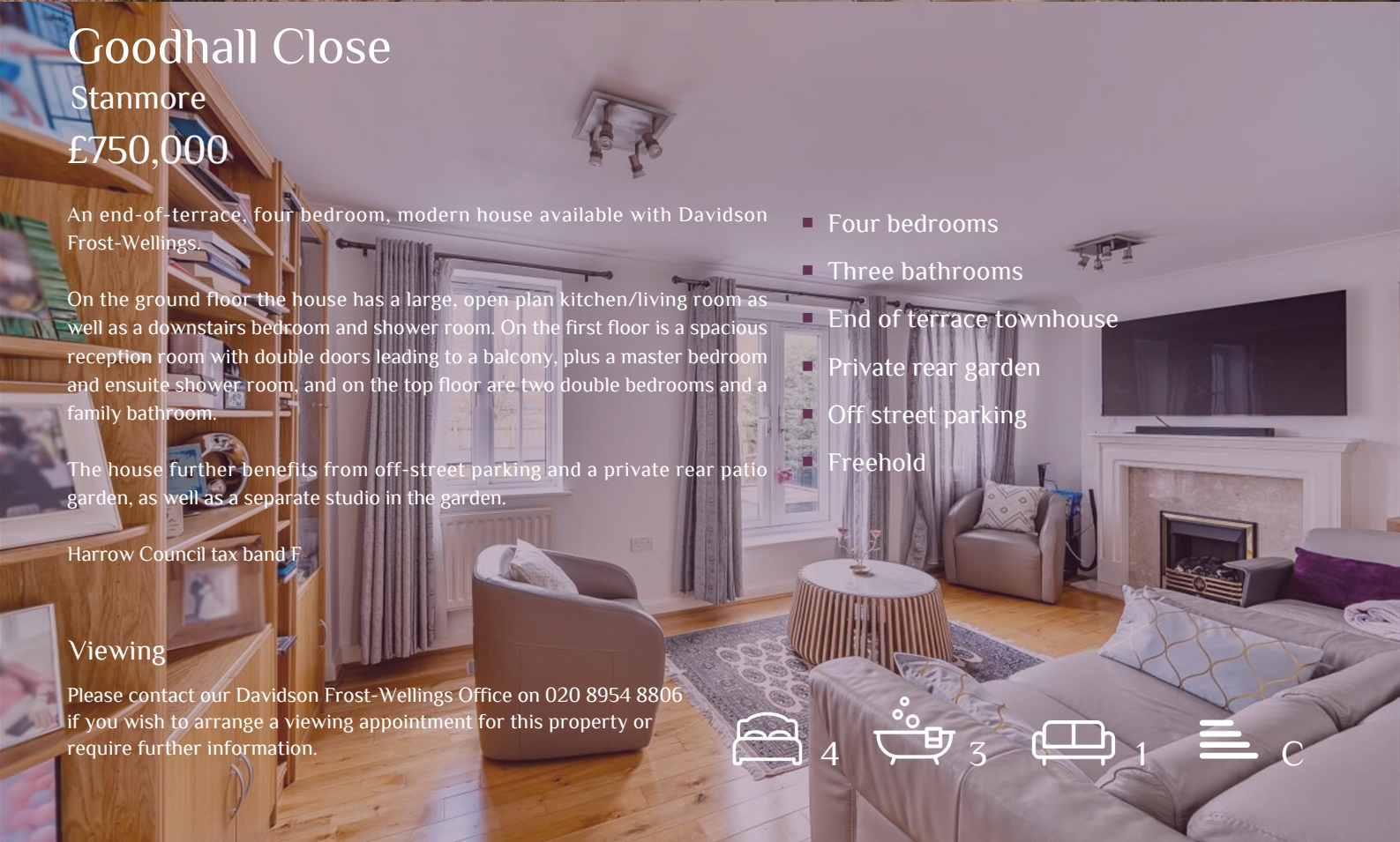

Floor Plan

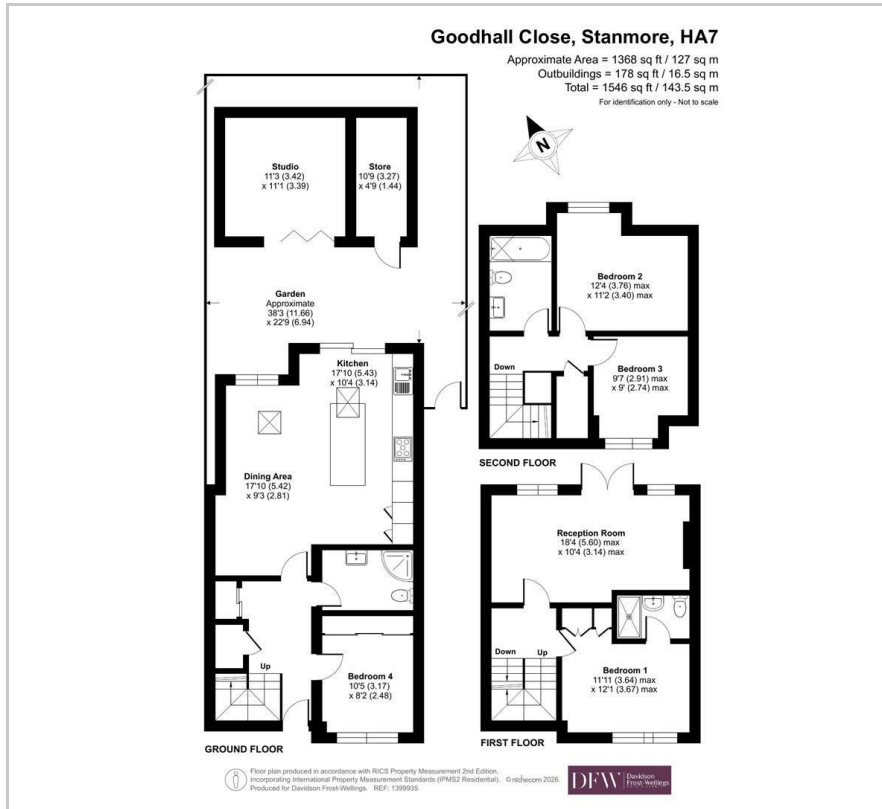

Area Map

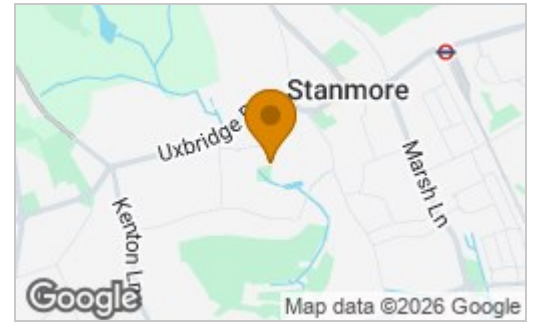

Energy Efficiency Rating

	Current	Potential
Very energy efficient - lower running costs		
(92 plus) A		
(81-91) B		
(69-80) C	78	82
(55-68) D		
(39-54) E		
(21-38) F		
(1-20) G		
Not energy efficient - higher running costs		
England & Wales	EU Directive 2002/91/EC	



These particulars, whilst believed to be accurate are set out as a general outline only for guidance and do not constitute any part of an offer or contract. Intending purchasers should not rely on them as statements of representation of fact, but must satisfy themselves by inspection or otherwise as to their accuracy. No person in this firm's employment has the authority to make or give any representation or warranty in respect of the property.